

FAG

624-2Z

Deep groove ball bearing

Schaeffler ID:
0382811980000

Deep groove ball bearing 62...-2Z, single row, shields, steel sheet metal cage

Technical information

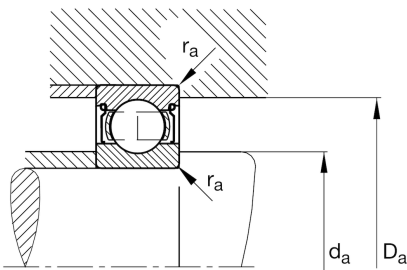
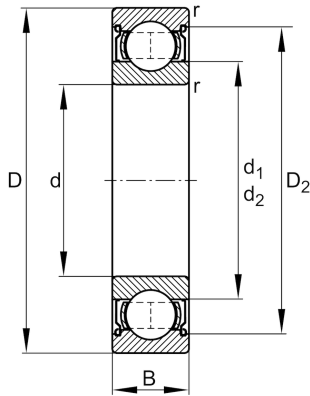
**Main Dimensions & Performance Data**

| | | |
|----------|--------------|-----------------------------------|
| d | 4 mm | Bore diameter |
| D | 13 mm | Outside diameter |
| B | 5 mm | Width |
| C_r | 1,306 N | Basic dynamic load rating, radial |
| C_{0r} | 487 N | Basic static load rating, radial |
| C_{ur} | 25.5 N | Fatigue load limit, radial |
| n_G | 61,000 1/min | Limiting speed |
| n_{gr} | 44,500 1/min | Reference speed |
| | 3 g | Weight |

Dimensions

| | | |
|-----------|----------|-----------------------------|
| r_{min} | 0.2 mm | Minimum chamfer dimension |
| D_2 | 11.35 mm | Caliber diameter outer ring |
| d_2 | 6 mm | Caliber diameter inner ring |

Mounting dimensions

| | | |
|------------|---------|--------------------------------------|
| d_{amin} | 5.8 mm | Minimum diameter shaft shoulder |
| D_{amax} | 11.2 mm | Maximum diameter of housing shoulder |
| r_{amax} | 0.2 mm | Maximum fillet radius |

Calculation factors

| | | |
|-------|------|--------------------|
| f_0 | 12.3 | Calculation factor |
|-------|------|--------------------|

Temperature range

| | | |
|-----------|--------|----------------------------|
| T_{min} | -30 °C | Operating temperature min. |
| T_{max} | 120 °C | Operating temperature max. |